

# UNO

## EN54-23 compliant LED strobe

This dual high output EN54 compliant LED strobe provides a high efficiency, low power solution for alarm signalling in an easy to install design.

The pre-alarm and alarm modes are individually monitored and operate different flash functions.

This VAD (visual alarm device) has a unique first fix installation method in the base enabling quick installation to provide a competitive solution.

The high quality and robust design ensures that the user has trouble free operation over the life of the product, even in tough environments.

With a range of selectable flash options, the product is suitable for a wide range of applications.



### Key Features

- Quick First fix installation
- Wide operating voltage
- Low power consumption
- High output mode
- Individual reverse polarity monitoring of pre-alarm and alarm circuits
- Selectable flash options
- Fully synchronised
- IP65 rated with Deep base
- Large EN54-23 coverage area

### Key Benefits

- Reduces costs where multiple VAD are required.
- Full synchronisation across tones and flashes on all products in the range enabling very flexible system upgrades and changes.
- Cover areas with fewer devices to reduce installation costs
- Robust and reliable, lower maintenance costs
- High specification and efficiency simplifies product selection

### Applications

- Hospitals, Shopping Malls, Commercial and Industrial sites, Transport, rail etc..
- Where 2 stages of visual alarm are required with a high output
- Where low power consumption is required with a high light output
- Where alarm signals must automatically over ride Pre-alarm signals

# Product data

## Specification

	Compliant operating range	Maximum Operating range
Supply voltage range	18—56 V dc	18 - 60V dc
Current consumption	20mA to 60mA dependent on setting	
Cable monitoring	Individual reverse polarity monitoring on both Pre-alarm and Alarm circuits	
Terminal size	0.28 to 2.5mm <sup>2</sup> conductor	
LED Configuration	Red and White LED's (Red above White)	
Mounting	Wall	
EN54 -23 coverage	Up to 720m <sup>3</sup> (see table below)	
Flash options	High and low output, 1s and 2s flash rates DIL switch selectable : White only / Red & White alternating, red only	
Material	V0 rated ABS base, V0 Polycarbonate lens	
Weight	220g	
Base colour	White or Red	
Lens colour	Clear	
Fixing method	Body to base – Bayonet auto connect, Base to wall - Screw	
Operating temperature	-25°C to +75°C	
IP Rating	Type B and IP65	

## VAD coverage

Switch Number	Function	UNO VAD EN54-23 code / coverage volume	
		WHITE flash	RED & White flash
0 0 0	1s Low power	W-3-8/192m <sup>3</sup>	W-3-8/192m <sup>3</sup>
0 0 1	1s High power	W-5-12/720m <sup>3</sup>	W-5-12/720m <sup>3</sup>
0 1 0	2s Low power	W-3-8/192m <sup>3</sup>	W-3-8/192m <sup>3</sup>
0 1 1	2s High power	W-5-12/720m <sup>3</sup>	W-5-12/720m <sup>3</sup>

## Dimensions

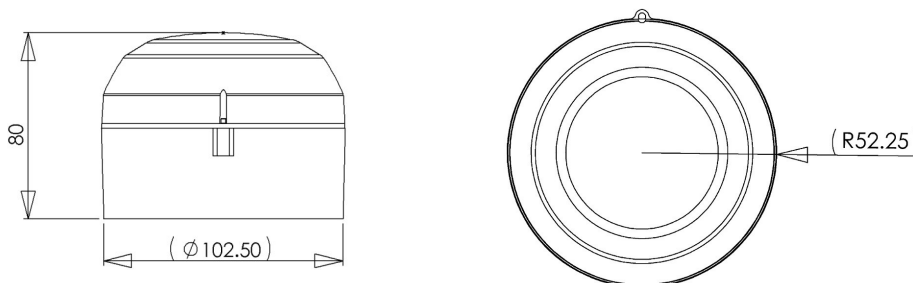

## Order codes

UNO-R-RW

Red deep base with Red and White high output strobes fitted

UNO-W-RW

White deep base with Red and White high output strobes fitted